



Easy steps to make a Cord Rosary.

Materials: No. 9 nylon cord, available in either ¼ lb. or 1 lb. tubes, white only. Plastic crucifixes or base metal crucifixes, plastic beads (60 needed for each Rosary), and tool for making knot. These supplies may be purchased from the Rosary Makers.

You will also need a pair of very sharp scissors and, we recommend, a bottle of clear nail polish or a jar of clear shellac with which to dip or brush the ends of the cord to make them stiff to easily go through the beads. This also eliminates any raveled ends.

Procedure: Use 60 inches of cord. Mark one end of cord at 8 inches for starting position. Dip or brush ends of cord with nail polish or clear shellac, if desired. Bonded cord gives the least chance of raveling, and you may decide there is no need to coat ends.

Make first knot at 8 inch starting position. Read instructions which follow and then refer to STEP 1 below. It is important to keep this 8 inches free on end. Place tool in left hand (reverse all instructions for left-handed person) and hold in a horizontal position as shown. Lay cord over grooved end of tool with grooved side facing towards you. Left thumb holds cord against the tool as right hand wraps cord around back of tool and brings it in front and crosses over the cord held by the left thumb to form an X. Remember this X is at the 8 inch starting position. Keep X in center of tool. With right hand, wrap two more loops around tool, one next to the other, working from right to left towards the handle of the tool. To secure knot, hold the loops with the left index finger; turn the tool from the horizontal position to a vertical position and with the right hand bring the long end of the cord through the groove in the tool under the wrapped cord inserting at the end of loops near handle. Pull long end of cord all the way through, but do not pull too tightly at this time. Remove knot from tool by taking hold of knot with index finger and thumb of right hand and pulling knot off the tool. Be sure each loop is kept one next to the other for a neat knot. Pull both ends of cord to tighten knot.

Instructions for making knot referred to in these instructions

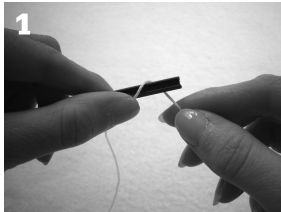

1. Wind cord clockwise over grooved metal tube.

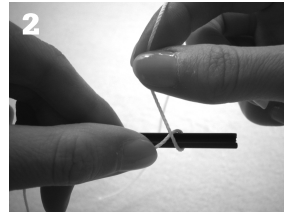

2. Cross cord over short length to form an X.

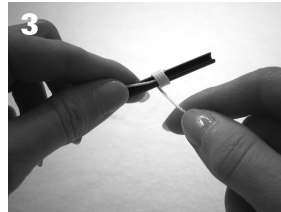

3. Wind cord around the tube four times. Be sure that cord passes over the tube behind the X toward the left hand.

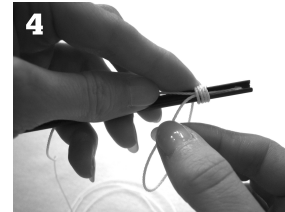

4. Slide end of long cord used for winding underneath all loops on tube from left to right (along groove).



5. Slip bead off metal tube. Holding right end cord tightly in the right hand, with the left hand twirl bead into position and tighten.

Put ten beads on cord for first decade. Always add beads on the long end of cord. As you begin next knot, hang beads on cord down in front of tool. Make knot same as before, but allow a bit of cord space so that when knot is tightened it may be positioned about the distance of one bead away from the bead to allow movement between beads as they are prayed. Before knot is tightened, it can be rolled into position.

Rosaries made without this extra space, so the beads can move slightly, do not have the necessary flexibility to allow the Rosary to be folded and carried in pocket or purse. A good handmade cord Rosary is never stiff.

Put on one bead for the "Our Father." Make knot, but be certain to roll knot down tightly against bead – leave no space between the knot and the bead. This bead is between two knots which are tightly against it.

Repeat for the next four decades.

After the five decades have been made, bring the two end knots together (the one at the beginning of the 1st decade and the one at the end of the fifth decade). You will then be holding a double cord. Refer to STEP 2 on back. Check to see if decades are even – knots can be moved slightly to make any adjustments if necessary. Plastic centers are not used; instead we will make a large knot using this double cord to join these cord ends.

CONTINUED >

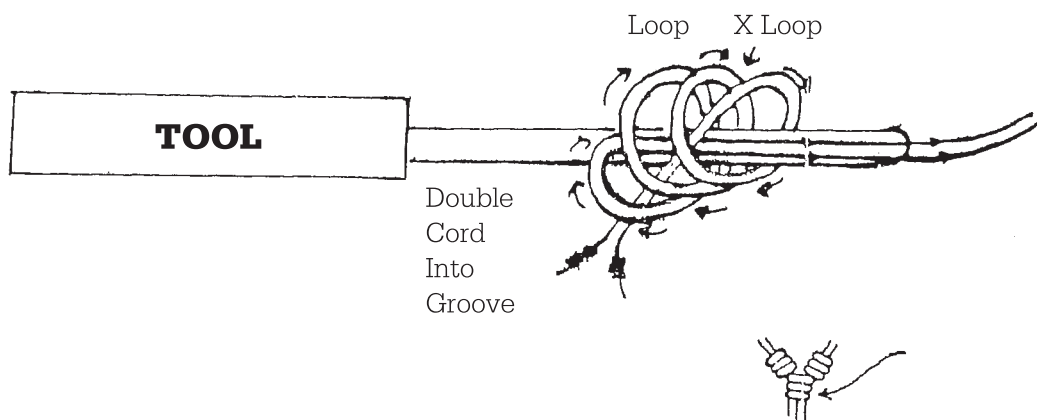
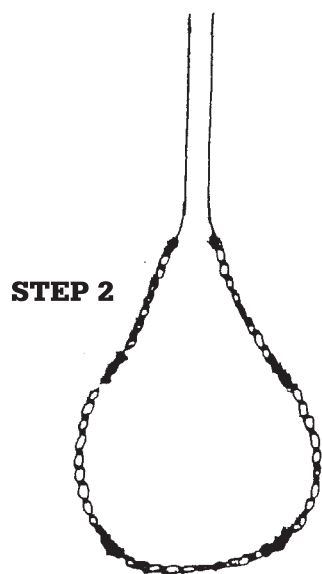

STEP 3 & 4

Using the longest cord only, put one bead on cord for the 'Our Father' bead. Make knot close to bead. Put on three beads. Make a knot, leaving about ¼ inch space between the bead and the knot. Put on another bead, but do not make the knot. Put on the Crucifix and reverse your work. Work from the Crucifix down to the beads. Leave a space between the Crucifix and the bead. Make a knot, wrapping the cord around the stay from the bead toward the Crucifix. Bring the cord up through the groove in the stay from the Crucifix to the bead.

Work the knot off the stay, pulling tight against the bead instead of the Crucifix.

Cut off the remaining cord close to the bead.

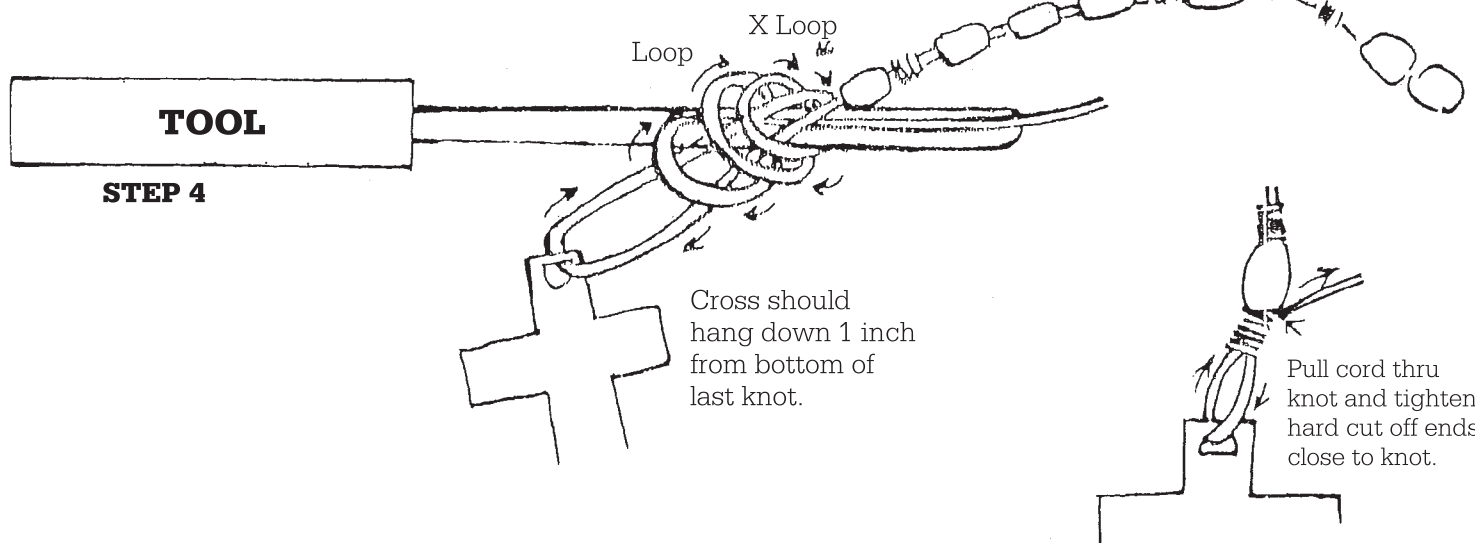

Please write to us if you need more information.

Our Lady's Rosary Makers

P.O. Box 37080 4611 Poplar Level Road Louisville, KY 40233

www.olrm.org